

► FEATURES

- A thermostatically controlled heater is provided to prevent the accumulation of snow and ice from covering the light output (optional)
- Designed for durability and withstanding shock and vibration
- Omnidirectional, 8" dia.
- Drop-forged dome and cast aluminum lower cover make the fitting sturdy, but lightweight too for ease of handling in the field
- The flat surface of the dome ensures that rough weather conditions do not impact the light output
- Protection degree: IP68
- Temperature range: -55°C to +55°C

► INSTALLATION

Suitable for 8" dia. Bases

Adaptor ring for installation on 12" dia. bases

Specific tools available for easy and precise installation

► COMPLIANCES

ICAO Annex 14 - Volume II

IEC TS 61827

NATO STANAG 3619

► APPLICATIONS

- Touchdown and Lift Off area (TLOF)
- Final Approach and Take Off area (FATO)
- Aiming Point

► BENEFITS

- Average LED life of 60000 hours at full intensity, but over 100000 hours in typical operating conditions
- Very low energy consumption compared to halogen lights which result in the lower size of CCRs and transformers
- Low life cycle costs due to long LED lifespan
- The LEDs emit light directly, without the need for colored filters, eliminating color shifts and energy losses
- Designed with simplicity allowing longer maintenance intervals and fewer spare parts
- No optical adjustment after LED module or lens array replacement

► PHOTOMETRIC PERFORMANCE

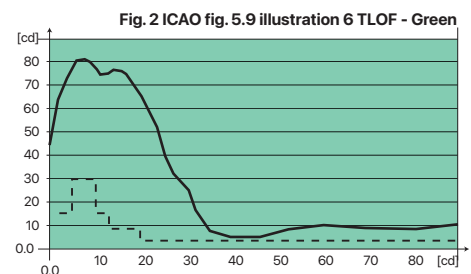
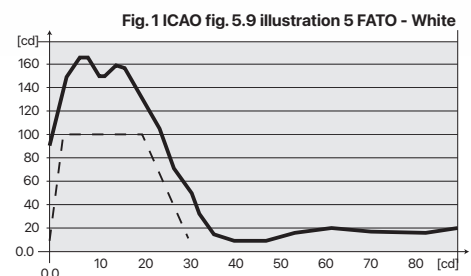

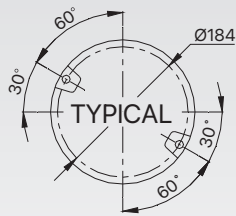

Light Fixture 8" dia.

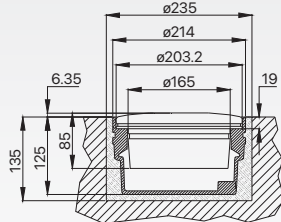

Shallow Base 8" dia.

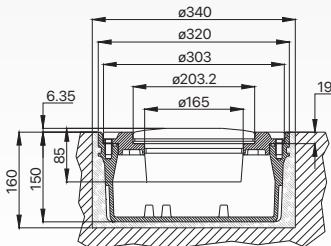

Shallow Base 12" dia.

MAIN COMPONENTS OF THE LIGHT UNIT

- 1 : Dome (Upper Cover)
- 2 : O-Ring for dome
- 3 : Prism
- 4 : Prism Gasket
- 5 : LED holder
- 6 : Optical Lens
- 7 : LED Module
- 8 : Lower cover with electronic
- 9 : Lower cover gasket
- 10 : Valve for Watertightness Test
- 11 : Gland
- 12 : Plug

** Refer to the relevant technical manual for the complete list of the available spare parts*



POWER FACTOR

Input Step	2.8A	6.6A
Power Factor	0.96	0.98

Heliport Layout

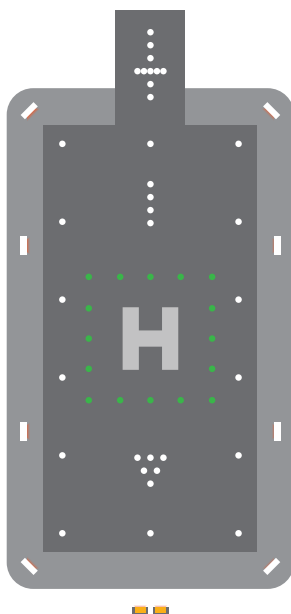

POWER CONSUMPTION

Electrical System	1 Plug
Omnidirectional 8" (w/o Arctic Kit) - 6.6 A	10 VA
Omnidirectional 8" (with Arctic Kit) - 6.6 A	30 VA
Omnidirectional 8" (w/o Arctic Kit) - 220 V	8 W

SHIPPING WEIGHTS & VOLUMES

	Light Unit	Shallow Base	Light Unit & Adaptor Ring
Weight(kg)	3.0	3.2	6.15
Volume(m³)	0.007	0.007	0.013

LHI G O O V

Basic P/N

Color

G = Green
W = White

Monitoring

O = Without Monitoring
M = With Monitoring

Supply Mode

V = 220 V
A = 6.6 A

Arctic Kit

O = Without Arctic Kit
A = With Arctic Kit

No.1, Mahdi Alley, Haji Pour Amir St., Sazman Aab Ave.
Sheikh Fazlollah Nouri Highway, Tehran, IRAN
Web www.tmb-co.com Tel 98 21 87740
Fax 98 21 8826 0707 P.O Box 1454643685